

410W/415W/420W/425W

Cortex™ series of solar modules by Omnis Power are very powerful which provide the world-class performance. The Cells and raw materials structure design ensures the maximized of sunlight and enhances the reliability. Cortex™ includes the most leading technologies of solar cells like PERC, N-Topcon, HJT, and shingled. After years of effort, Cortex is able to increase customer's value beyond the efficiency, the performance and durability under real conditions makes our customers succeed no matter in residential or commercial applications.

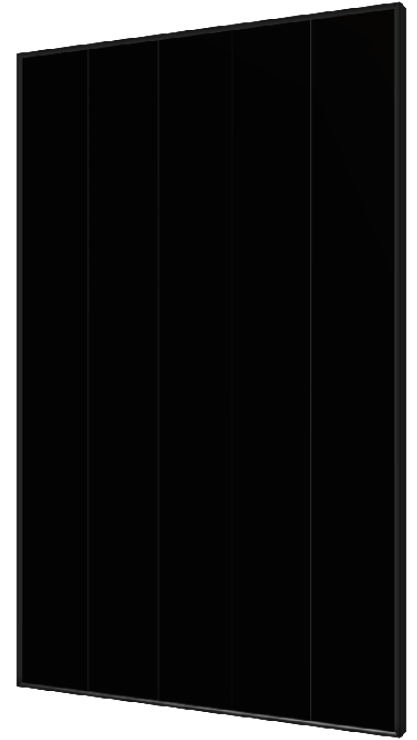

Highlight



Higher Efficiency

The leading high efficiency of solar cells ensures the high output power which making it more sufficient in limited space.



Lower Power Degradation

Ensured PID resistance through cell process and module material control to help harvest more. Cortex is guaranteed ONLY 0.5% annual power degradation in 30 years.



Warranty Extended Up To 25 Years

Cortex provide 25 years warranty of product materials and workmanship which is leading the whole industry.



Durability In Extreme Conditions

Cortex is passed the test by salt mist, ammonia and mechanical loads up to 5400pa positive.

About Omnis Power

In the year of 2010, Omnis power was created by a group of passionate people in U.S who are dedicating into renewable energies. Since more than 10 Years, Omnis Power has grown to become one of the most innovative and dependable solar product and solution provider. Omnis Power offers sustainability and brings the future to both commercial and residential applications worldwide with top-of-the-line solar products, solutions, and services. Being an qualified PV company means operating in a way that reflects our values and mission to provide our partners with the innovation and quality they deserve. Omnis Power is committed to upholding the standards and responsibility that made us one of the best.

Electrical Data (STC)

Part Number	OP410M44-SHI-BB	OP415M44-SHI-BB	OP420M44-SHI-BB	OP425M44-SHI-BB
Peak Power Watts- $P_{MAX}(Wp)^*$	410	415	420	425
Power Output Tolerance	0~3%			
Open Circuit Voltage- $V_{OC}(V)$	41.40	41.50	41.60	41.70
Short Circuit Current- $I_{SC}(A)$	12.65	12.80	12.92	13.03
Maximum Power Voltage- $V_{MPP}(V)$	34.40	34.40	34.50	34.60
Maximum Power Current- $I_{MPP}(A)$	11.97	12.08	12.19	12.30
Panel Efficiency(%)	20.60	20.90	21.10	21.40

STC :Irradiance 1000w/m², Cell Temperature 25°C Air Mass AM1.5 *Power Binning: +/-5W

Electrical Data (NMOT)

Maximum Power- $P_{MAX}(Wp)^*$	309	312	316	320
Open Circuit Voltage- $V_{OC}(V)$	39.50	39.60	39.70	39.80
Short Circuit Current- $I_{SC}(A)$	10.19	10.31	10.41	10.50
Maximum Power Voltage- $V_{MPP}(V)$	32.80	32.80	32.90	33.00
Maximum Power Current- $I_{MPP}(A)$	9.41	9.53	9.62	9.70

NOCT: Irradiance at 800W/m², Ambient Temperature 20°C, Wind Speed 1m/s

Mechanical Data

Panel Dimension(H/W/O)	1812×1096×30mm
Weight	20.8kg±0.3mm
Cell Type	Mono-crystalline solar cell
Cell Orientation	305(61*5)
Front glass	tempered glass, 3.2mm
Frame	Anodized aluminum profile
Junction Box	IP68, two diodes
Cable	4mm ² , +300mm/-1000mm(Vertical), +220mm/-180mm(Horizontal)

Temperature Ratings

NMOT	42.30°C(±2°C)
Temperature Coefficient of P_{MAX}	-0.34%/°C
Temperature Coefficient of V_{OC}	-0.27%/°C
Temperature Coefficient of I_{SC}	+0.04%/°C

(Do not connect Fuse in Combiner Box with two or more strings in parallel connection)

Maximum Ratings

Operational Temperature	-40~±85 °C
Front/Rear Side Load	5400/2400pa
Max Series Fuse Rating	25A
Max System Voltage	1500V (IEC)
Fire Rating	Class 1(UNI9177)

Warranty

25 years Product Workmanship Warranty
30 years Output Power Warranty

Packaging Configuration

Modules per box:36 pieces
Modules per 40' container:924 pieces

DIMENSIONS OF PV MODULE(mm)

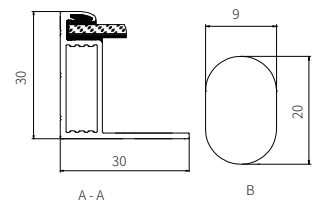
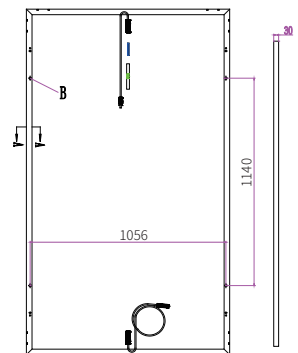
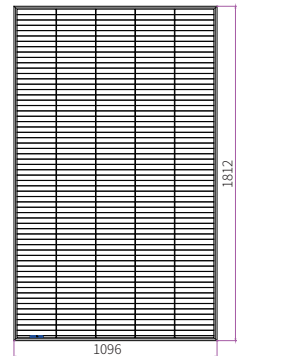

I-V CURVES OF PV MODULE

